

EM Lock Installation Guide

Model	FA-600C	FA-600PoEN
Static Strength	Up to 600 lbs	
Voltage Input	12 VDC	
Current Draw	480mA	330mA
Dimension	(L)250 x (W)42 x (T)25 (mm)	

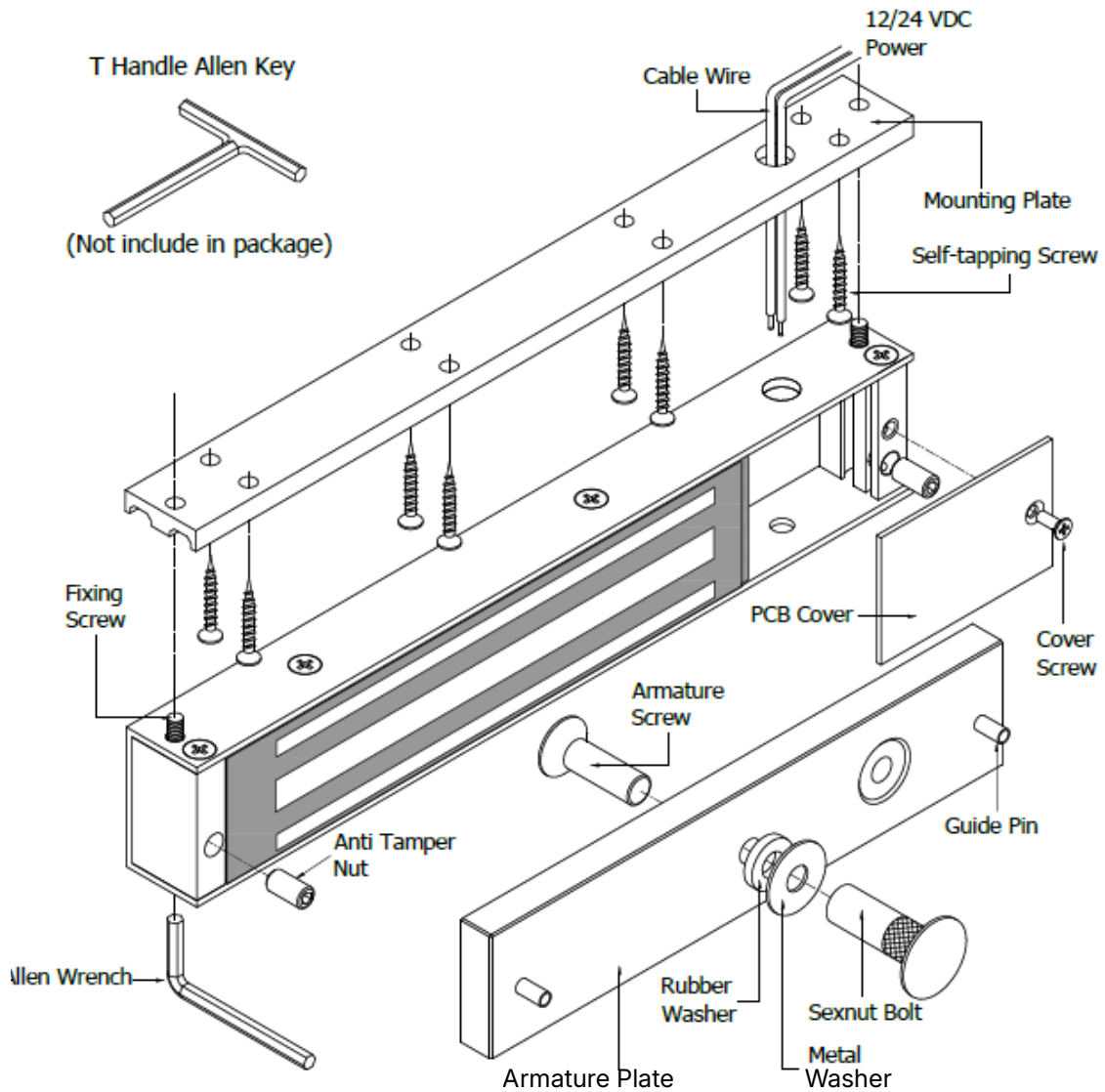

General Installation Steps & Maintenance

1. Fold installation template along dotted line to 90°.
2. Close door and position template on lock-jamb side, 10 mm gap.
3. Mark and drill holes per template.
4. Install mounting plate on door frame.
5. Pull cable through frame into lock housing.
6. Loosely tighten screw through mounting plate's adjustable slot.
7. Install the armature plate onto the door.
8. Screw using the proper "T"-handle Allen key.
9. Align mounting plate and armature plate, then tighten balance screws.
10. Unscrew anti-tamper nut with Allen wrench and install lock by tightening fixing screws.
11. Secure anti-tamper nuts to prevent unauthorized access and fully tighten all fixing screws.

Wiring & Safety Requirements

1. Connect power wires in accordance with NFPA 101.
2. All wiring must be completed inside a protected area.
3. Typical wiring methods shall comply with CSA C22.1, Canadian Electrical Code, Part I.
4. Follow Safety Standards for Electrical Installations, Section 32.

Trouble Shooting

1. Door not locked: wrong wiring / no power, wrong voltage or wire size, PCB modified.
2. Reduced holding force: dusty/damaged surface, poor magnet-armature contact, improper magnet install, armature not fully contacting → ensure armature is loose for self-alignment.
3. Sensor not functioning: wiring or power issue.

General Installation Steps & Maintenance

Distance from 12VDC power supply to furthest lock unit

Current (A)	10 m	20 m	30 m	40 m	50 m	75 m	100 m	125 m	150 m	300 m
0.25	18	18	18	18	16	14	14	12	12	12
0.5	18	18	18	14	14	12	12	12	12	—
0.75	18	18	14	14	12	12	12	—	—	—
1	18	16	14	12	12	—	—	—	—	—
1.5	18	16	16	14	12	—	—	—	—	—
2	18	18	16	12	—	—	—	—	—	—

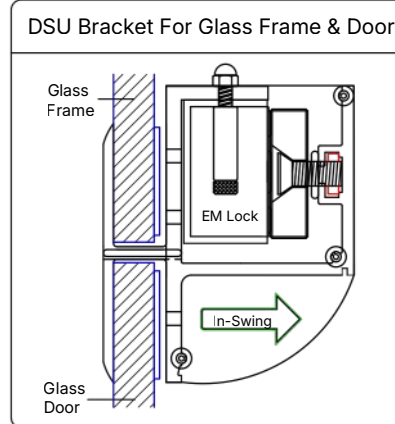
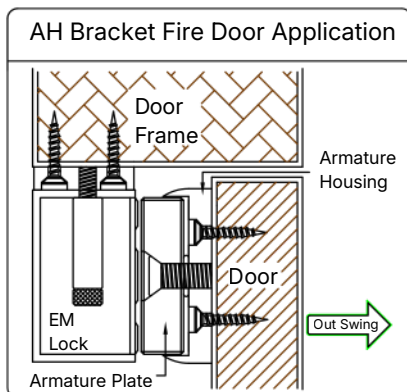
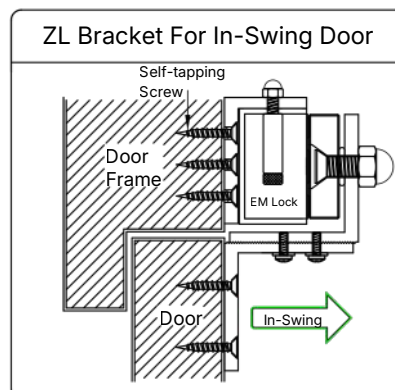
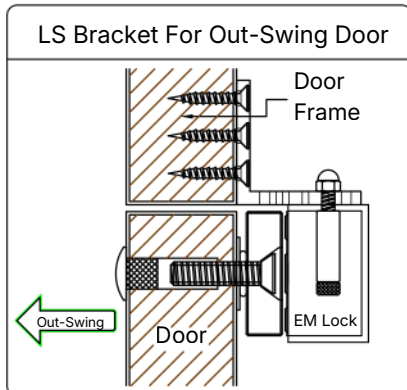
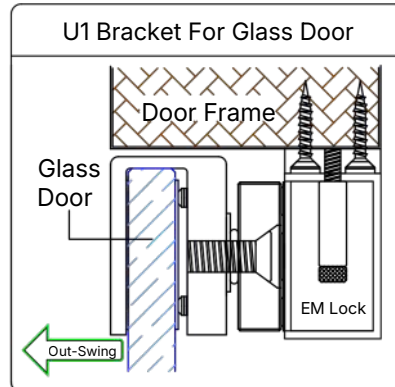
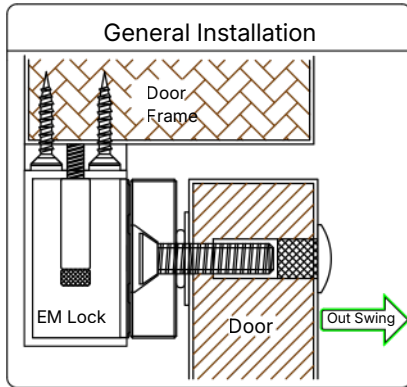

Basic Bracket Installation

Out Swing Door

Installation Template

Fold the Installation Template along the dotted line up to 90° (1)

Door Frame
Template
Close door; align template on lock-jamb side with 10 mm gap.

Door Frame
Door
Mark & drill holes according to template indications.

Door Frame
Door
Using template, drill 3 holes in frame and 3 in door.

Armature Screw
Armature Plate
Rubber Washer
Metal Washer
Attach armature plate to door, ensuring it can pivot around the screw. Note: Do not overtighten.

Wooden Door
Door
Pivot armature plate around screw to compensate for door misalignment.

EM Lock
Door
Connect power and test. Ensure magnet and armature plate are properly aligned for normal operation.

Holding Force
Door
EM Lock

EM Lock
Door
Connect power and test. Ensure magnet and armature plate are properly aligned for normal operation.

EM Lock
Door
Connect power and test. Ensure magnet and armature plate are properly aligned for normal operation.

ZL Bracket for In-Swing Installation

In Swing Door

EM Lock
Door
Minimum door frame height "L" for brackets:

- 300ZL = 39 mm
- 600ZL = 46 mm
- 800ZL = 52 mm
- 1200ZL = 73 mm
- 1500ZL = 76 mm.

L-Bracket
Frame
Place L-bracket near top door corner, ≥10 mm gap; ensure door closes.

EM Lock
L-Bracket
Tighten EM lock on L-bracket with Allen wrench.

EM Lock
L-Bracket
Tighten EM lock on L-bracket with Allen wrench.

Z-Bracket
Flat Washer
Rubber Washer
Armature Screw
Assemble Z-bracket and ensure it adjusts freely before final tightening.

Armature Plate
Z-Bracket
Install armature plate on Z-bracket using the provided CSK screw.

Power Supply
EM Lock
Door
Power on EM lock, let armature plate attach, and adjust Z-bracket position on door.

Power Supply
EM Lock
Door
Attach armature plate to Z-bracket with supplied CSK screw.

LED Status:
> Green = Locked
> Red = Released
> Off = No Input
(Only for LED Models)

12 VDC Setting
24 VDC Setting

12 / 24 VDC Power Output
12 / 24 VDC Power Input
N.O.
N.C.
C
Hall Effect Sensor Output (Only for LED Models)
Hall Effect Sensor Input (Only for LED Models)

Caution Against Changing Factory Applied Settings !

Set the jumper position according to the power input correctly before switch ON the power.

(1) Installation Template only applicable for model lock 300, 600, 800, 1200.

All drawing shown are for illustration purpose only. Actual product may vary due to product enhancement.