

# Smoke Detector Camera

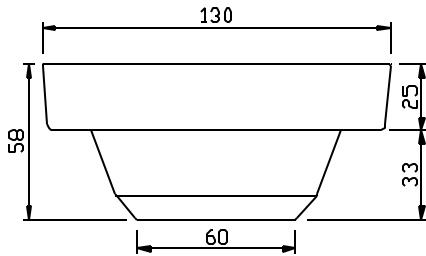

## Description

SDC series Color Dome are high-performance CCD cameras specially designed for indoor, covert surveillance.

The casing is made of high quality ABS & PC plastic, to ensure light weight, tough, long lasting & remain maintenance free for many years.

Various high quality camera module are used to ensure customer satisfaction for each installation.

## Features

- Low cost & excellent performance
- Compact design
- Easy installation
- Reverse polarity protection
- Wide Voltage Range 9-14VDC
- Lens Option

Lens Size (mm)	2.9	3.6	6.0	8.0	12.0
Viewing Angle	130°	92°	53°	40°	28°
Recognizable Distance(m)	3.0	3.5	6.0	8.0	12.0
Best Pic.Distance(m)	1.2	1.5	2.3	3.0	4.0

## Specification

Model	<b>SK-390SD</b>	<b>SK-470SD</b>	<b>SK-475SD</b>	<b>SK-490SD</b>	<b>SK-490BSD</b>
Color/B&W	B/W	Color			
CCD	1/3" LG	1/4" Sharp	1/3" Sharp	1/3" Sony	1/3" Sony
Effective Pixels	512(H) x 582(V)				
Synchronization	Internal				
Lens	3.6mm Standard, 2.9/6.0/8.0/12.0mm Optional				
Horizontal Resolution	420 TV Lines	380 TV Lines	420 TV Lines	420 TV Lines	480 TV Lines
Minimum Illumination	0.1 Lux	1.0 Lux	1.0 Lux	0.5 Lux	0.05 Lux
S/N Ratio	48dB				
Electronic Iris	1/60 to 1/100,000s				
Video Output	1Vp-p Video Composite				
Power Source	9-14VDC				
Operating Temperature	0° to +50° C				
Weight	150g				