

Pinhole Camera



Description

MCC series Pinhole are high-performance cameras specially designed for indoor, low profile surveillance.

The casing is made of Aluminum with non-reflective epoxy powder coating, providing a tough, light weight and good heat conductor for the camera.

Features

- Compact size & Light Weight
- Mounting Bracket Included
- Easy installation
- Reverse polarity protection
- Wide Voltage Range 9-14VDC
- 3.7mm Wide Angle Lens
- B/W : MCC-400P1 & 500P1
- Color : MCC-700P1

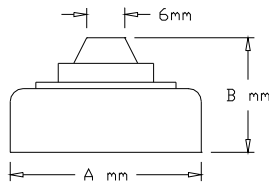

Dimension	400P1	500P1	700P1
A	30	25	30
B	18	19	18

Specification

Model
Signal
Pick-up Device
Effective Pixels
Synchronization
Lens
Horizontal Resolution
Minimum Illumination
S/N Ratio
Electronic Iris
Video Output
Power Source
Operating Temperature
Weight

MCC-500PI	MCC-850P1
B/W	Color
1/3" CCD	1/4" CCD
512(H) x582(V)	
Internal	
3.7mm(Cone Type)	
380 TV Lines	330 TV Lines
0.1 Lux	1.0 Lux
48dB	
1/60 to 1/100,000s	
1Vp-p Video Composite	
12VDC, Approx 1.2W	12VDC, Approx 1.65W
-10 ⁰ to +50 ⁰ C	
40g	48g